

HOLE LAYOUT
TOP VIEW ± 0.05

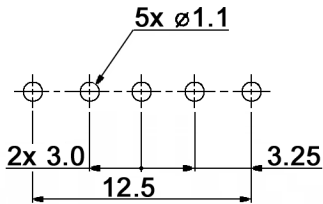

CIRCUIT DIAGRAM
C: COMMON PIN
BOTTOM VIEW

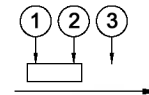

Specifications:

- Contact rating: 0.2A, 30V DC
- Contact resistance: 30mOhm max.
- Insulation resistance: 100MOhm min. at 500V DC
- Dielectric strength: 500V AC (50/60Hz, 2mA) for 1 minute
- Operating temperature: -10°C to +60°C
- Mechanical life: 5 000 cycles
- Operating force: 150 +/-70gf
- Soldering conditions: 260°C max., 5 +/-1sec
- Timing: non-shorting
- Material: Terminal / contact plate: brass strip, silver plated
Frame: SPCC, nickel plated
Base: phenolic resin, natural
Spring: SWC, temper
Slider: nylon, black

Compliance: RohS II (2011/65/EU)

| | | | | |
|---|------|-------|-----------------------|-----------------------|
| Tolerances: up to 10: ±0.2mm above 10-50: ±0.3mm | | Date | Name | <h1>MFP 121 D-RA</h1> |
| | | 06/17 | dr | |
| | | | | |
| | | | | |
| | | | | |
| | | | knitter-switch | <h2>30 38 89</h2> |
| Modifications | Date | Name | | Page 1/1 |